

LED Emergency Exit Sign Mulu

Please read these instructions thoroughly before use and retain for future reference.

Products Covered:

MUL0105

MUL0105-BLK

The Emergency Luminaire or Emergency Exit Sign is a surface mounted maintained or non-maintained luminaire supplied with adaptable self-adhesive graphics that can be arranged to indicate escape routes as necessary.

Safety Information

- Installation must be carried out in accordance with national building and wiring regulations.
- If you are in any doubt about installing this product, please consult a qualified electrician.
- The LED module light source contained in this luminaire shall only be replaced by the manufacturer, service agent or a similar qualified person. **Dangerous voltage may be accessible with the diffuser removed.**
- Before commencing installation or servicing, turn off and isolate the circuit to be worked on by removing the fuse or switching the circuit breaker off at the distribution board.
- This product is suitable for connection to a 220-240Vac 50/60Hz supply.
- This is a **Class II, IP65** rated product and does not require an Earth though a terminal marked **E** is provided for Earth continuity.
- The emergency fitting is not suitable for use on a battery supply, trickle or intermittent re-charging circuit.
- The emergency fitting is not protected against supply voltage polarity reversal.
- When cutting holes, drilling or screwing take care not to damage existing wiring or pipework.

Installation Information

- Referring to the diagram supplied as below for wall installation.
- The luminaire can be used in both **maintained** mode (normal operation and emergency operation) or **non-maintained** mode (emergency operation only) according to the wiring as diagram below.
- Ensure that all electrical connections are tighten with no loose strands and secure any glands as necessary.
- **Ensure battery is connected.**
- Write the commissioning date on the battery label.
- Stick the Maintained or Non-Maintained emergency luminaire label on the luminaire where it can be seen.
- The battery leaves the factory in a charged state but may take up to 24 hours to fully charge for a 3-hour duration test. Charge for 5 minutes before performing a functional test to ensure there is some charge in the battery.
- There is a button on the lower edge to quickly do a functional emergency test.
- To fully test the emergency function, the supply will need to be turned off.

Exit Sign Graphics

- Adaptable graphics are supplied for applying to the front of the luminaire to use it as an emergency exit sign.
- Apply the self-adhesive exit and arrow graphics according to the escape route direction.

At the end of product life, the product should be disconnected from the mains supply by a suitably qualified person and dismantled into its constituent parts prior to disposal. Only commonly available tools* such as screwdrivers, knives, soldering irons, spanners, pliers etc should be used and appropriate safety measures taken during their use. Parts such as LED strips, arrays, electrical control gear, PCBs, wiring, plastic diffusers, metal components such as back plates or heatsinks should all be separated from the product and disposed of via appropriate waste streams. Please consult your local authority for WEEE recycling and disposal options.

*List of commonly available tools is not exhaustive, if in any doubt please contact Kosnic.

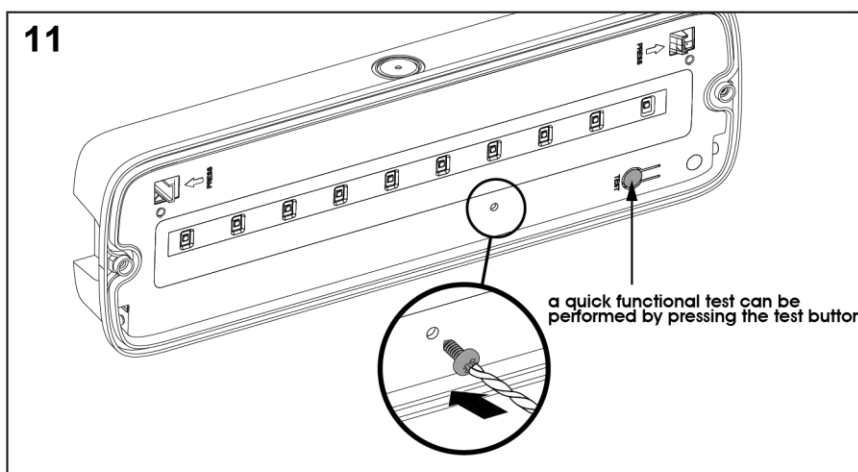
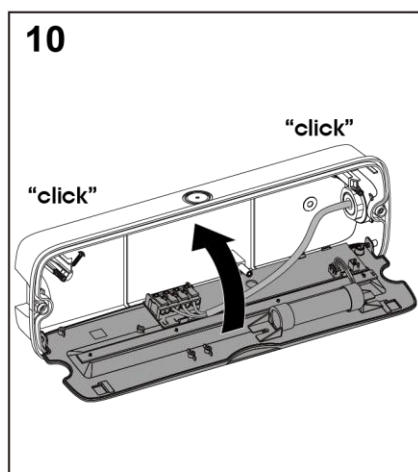
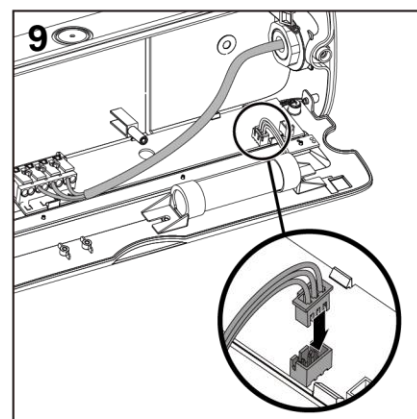
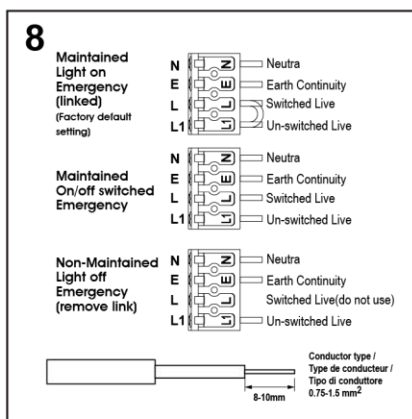
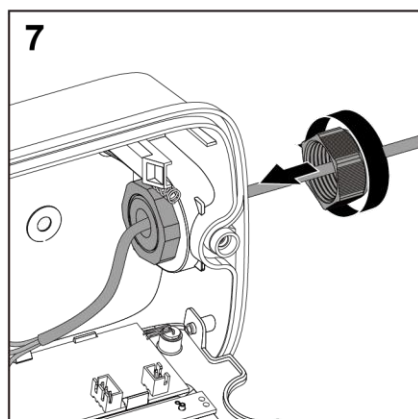
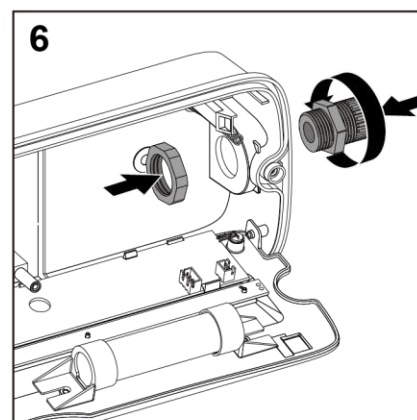
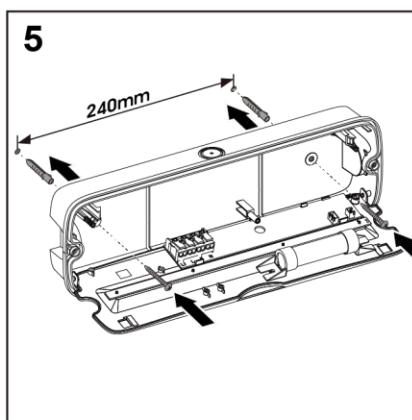
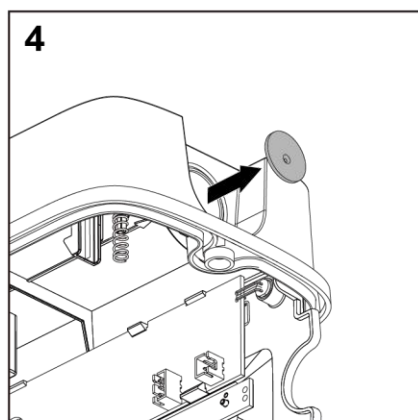
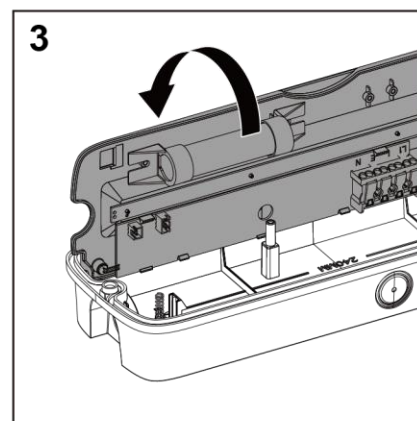
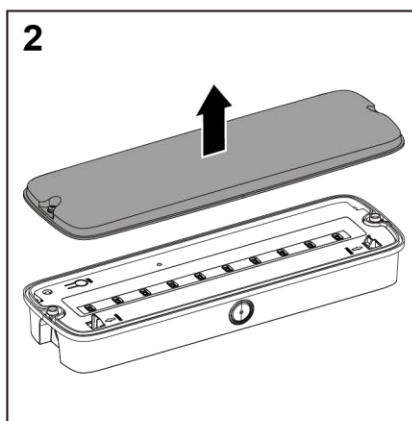
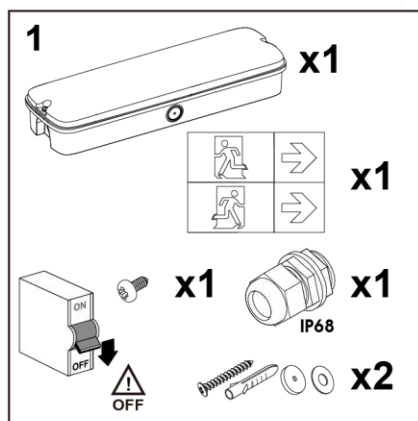

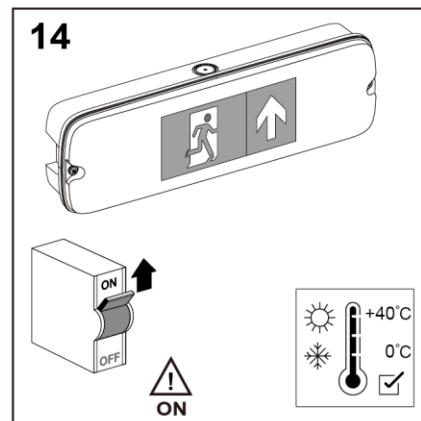
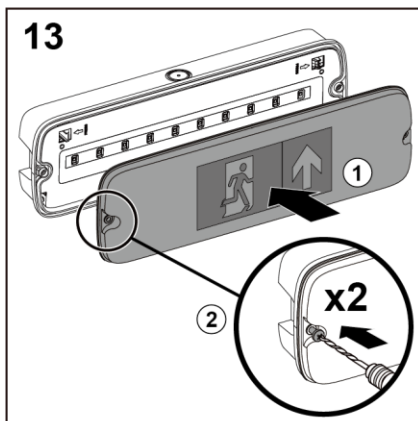
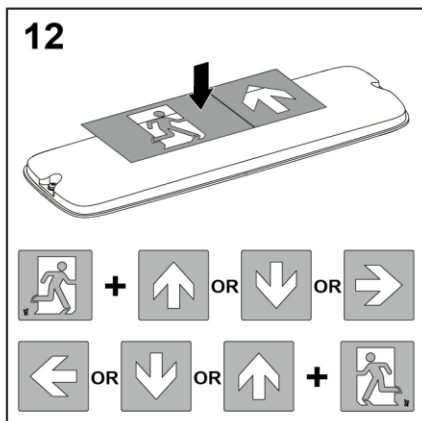

Battery Replacement / Remplacement de la batterie / Sostituzione della batteria

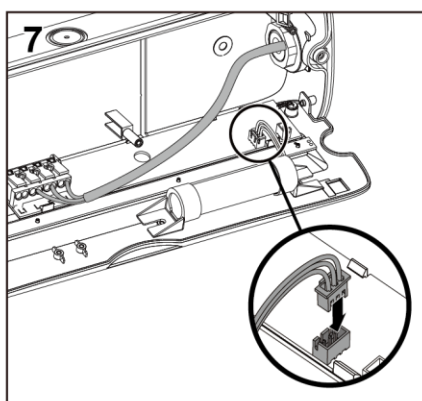
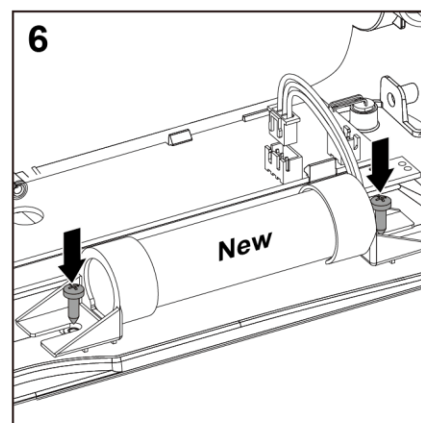
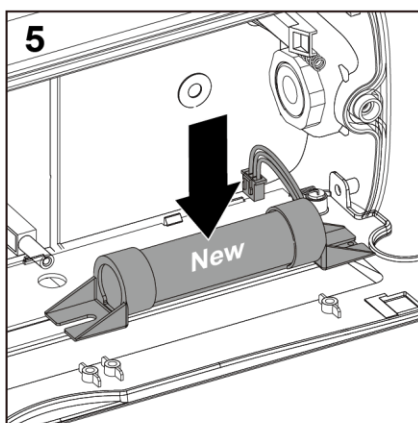
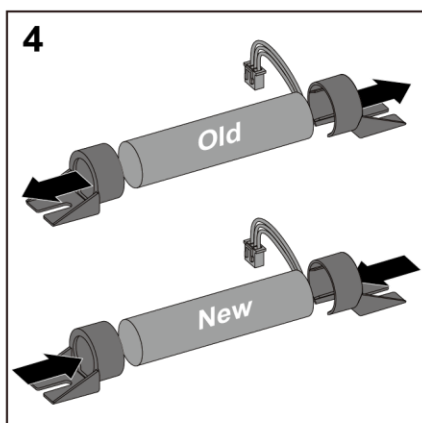
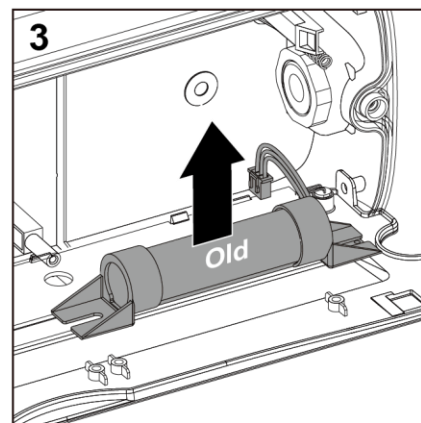
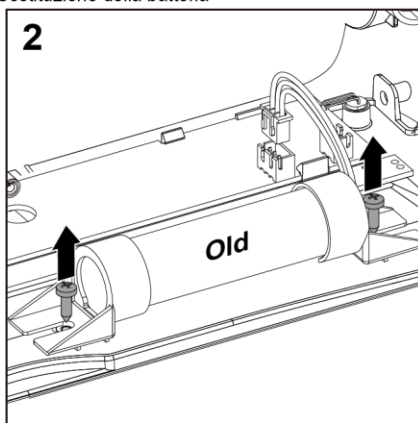
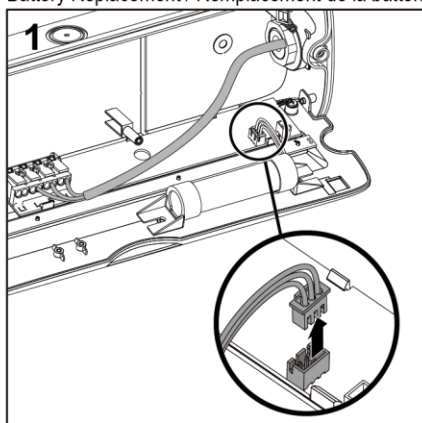

The Waste Electrical & Electronic Equipment Regulations (WEEE) require that products bearing this symbol must not be disposed of with household waste as they may contain substances harmful to the environment. The Local Authority can provide advice on recycling.